

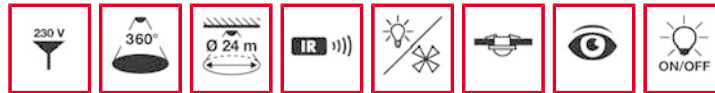

Order description  
PDE 360i/24 white

Order number  
EM10425110

EAN code  
4015120425110



**Short description:**

- Recessed ceiling-mounted presence detector with 360° field of detection for demand-responsive lighting control and therefore noticeable energy cost reductions
- With a large **range of up to 24 m** in diameter for use in offices, classrooms and board rooms, for example, and passageways with natural lighting
- Ideal for **use in areas with ceilings of up to 10 m**, such as sports halls and warehouses
- With 16 A high-performance relay (tungsten pre-contact), ideal for switching capacitive loads such as electronic ballasts, parallel-compensated fluorescent lamps, compact fluorescent lamps, energy-saving lamps
- Automatic light control depending on presence and natural light
- Additional switch contact "HVAC" for controlling heating, ventilation and air conditioning depending on presence
- Can be programmed by remote control, e.g. continuous lighting ON/OFF and automatic storage of the current light value
- Small overall dimensions with a ceiling cut of only Ø 68 mm make this detector inconspicuous but effective in its application
- Designed as a recessed ceiling-mounted device, in particular for suspended ceilings, with replaceable white cover IP 44
- Modular plug contacts between power box and sensor
- Power box installation/connection - on completion of the painting work the sensor can be simply plugged into the power box
- Additional switch input for individual manual lighting control
- Default settings ensure immediate operability
- In-built impulse feature for controlling automatic stairwell lights or control devices and for use in facility management/PLC
- The field of detection can be extended by connecting a "slave" presence detector

**Technical data:**

Mains voltage	230 V AC, 50 Hz
Approx. power consumption	1.2 W
Viewing distance	360°
Range	approx. 24 m diameter, at an installation height of 3 m
Setting options	electronically by infrared Mobil-PDi/MDi remote control (order separately)
<b>Channel 1</b>	<b>lighting</b>
Switching capacity	230 V AC, 50 Hz/(16 A relay), 2300 W/10 A (cos phi = 1), 1150 VA/5 A (cos phi = 0.5), capacitive load/electronic ballasts - max. inrush current 450 A/200 µs
No. of switchable electronic ballasts	30 x (1 x 18 W), 20 x (2 x 18 W), 25 x (1 x 36 W), 15 x (2 x 36 W), 20 x (1 x 58 W), 10 x (2 x 58 W)
Switch input 1	yes
Time setting	impulse/approx. 1 - 15 mins.
Light measurement	mixed light
Light value	approx. 5 - 2000 Lux
<b>Channel 2</b>	<b>HVAC</b>
Contact	floating 230 V AC/2 A, 24 V DC/2 A
Max. switching capacity	100 W/460 VA
Time setting	impulse/approx. 1 - 60 mins.
Slave input	yes
Permissible ambient temperature	0 °C...+50 °C
Protection type	power section IP 20, sensor cover IP 44
Protection class	II
Test symbol	TÜV Süd
Installation type	recessed ceiling mounting
Housing material	UV stabilised polycarbonate
Approx. measurements	Power section: depth 122 mm x width 58 mm x height 27 mm Sensor: height 72 mm, Ø 100 mm
Colour	white, similar to RAL 9010

**Accessories**

- EM10425035 - MD/PDE 360/8 Slave white
- EM10425134 - MD/PDE 360/24 Slave white
- EM10425486 - Cover 360/24-E silver
- EM10425509 - Mobil-PDi/MDi silver/metallic blue
- EM10425615 - Basket guard 165/70 white
- EM10980701 - RC-filter aluminium appearance

**Note:** Order remote control separately.



Order description  
PDE 360i/24 white

Order number  
EM10425110

EAN code  
4015120425110



Dimensions in mm

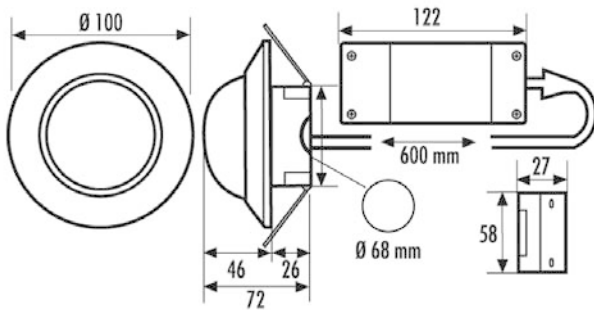

Schaltplan

Präsenzmelder			
PD 360i/8 - Master	PDE 360i/8 - Master	PD 360/8 Slave	MD/PDE 360/8 Slave
PD 360i/24 - Master	PDE 360i/24 - Master	PD 360/24 Slave	MD/PDE 360/24 Slave
PD 360i/Korridor - Master	PDE 360i/Korridor - Master		

Kombinierbar mit Slave-Ausführung

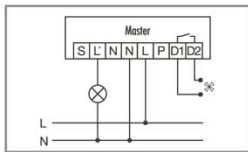

Standardbetrieb

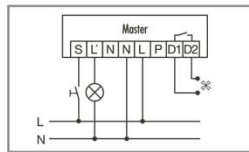

Standardbetrieb mit zusätzlicher Ansteuerung durch Schlieftaster. Bei Bedarf kann das Licht durch den Taster manuell ein- bzw. ausgeschaltet werden.

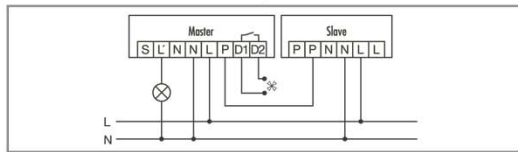

Master-Slave-Schaltung: Das Master-Gerät schaltet angeschlossene Verbraucher je nach eingestellten Parametern. Die Slave-Geräte dienen nur der Bewegungserfassung und geben bei erkannter Bewegung einen Impuls an das Master-Gerät.  
**Achtung:** Es können max. 10 Slave-Geräte an ein Master-Gerät angeschlossen werden.

**Hinweis:** Eine Parallelschaltung der Präsenzmelder ist nicht zulässig. Zur Erweiterung des Erfassungsbereiches die zugehörigen Slave-Geräte (Zubehör) nutzen.

www.esylux.com