

**PRESS RELEASE**

Ahrensburg/Frankfurt, 18 March 2018

# **Pre-configured, ready-to-install, biologically effective: ESYLUX Light Control set solutions for classrooms and hospitals**

**At the Light +Building trade fair, ESYLUX will be introducing Classroom and Patient Room Sets: ready-to-install, pre-configured system solutions with ESYLUX Light Control (ELC) that allow for standardised lighting in schools and hospitals. These solutions provide energy-efficient human centric lighting and have been adapted to the specific requirements of both places of use. The sets contain all components under one item number — and like all other ELC system solutions, they can be used immediately thanks to plug-and-play technology.**

There are many types of building in which standardised room sizes are used, for example classrooms in schools or two-bed patient rooms in hospitals. ESYLUX has developed its Classroom and Patient Room Sets in order to provide intelligent and easy-to-install automation and lighting solutions for both types of room. The system solutions are pre-configured and ready to install, and feature ESYLUX Light Control (ELC) control technology and plug-and-play installation.

## **Classroom Sets with vertical whiteboard lighting**

The Classroom Sets are designed for use in standard classrooms approx. 60 m<sup>2</sup> in size. The sets include ceiling system lights in various designs and sizes, system presence detectors that are either integrated into the lights or provided as separate devices, system control units, all necessary plug-and-play system cables

and an ESYLUX DALI push button. A glare-free board light, integrated into the system via a switching module (also included), vertically illuminates presentation surfaces.

When in operation, the system delivers a vitalising biologically effective light with a high level of energy efficiency thanks to the adaptive SymbiLogic HCL light control from ESYLUX. SymbiLogic technology creates two zones of lights based on their proximity to the windows. Each zone can then be controlled separately, enabling optimal use of natural daylight. The button can be used to easily override the system and adjust brightness and light colour at any time, or call up individual scenes. If the room is empty, the presence detector automatically switches off the lighting.

### **Patient Room Sets with examination and orientation lighting**

The Patient Room Sets are designed for use in standard two-bed hospital rooms approx. 20 m<sup>2</sup> in size. In addition to the system components and a DALI push button, this set also includes a separate downlight that can be time-controlled at night to act as a safe orientation light. The DALI push button can be used to set separate examination lighting for each scene with an illuminance of 1000 lux — allowing the area around each bed to have individual lighting levels. Even in normal mode, the system delivers energy-efficient SymbiLogic human centric lighting, which can benefit health. If a room is temporarily unoccupied, the presence detector ensures that the lighting is switched off automatically a short time after anyone has been in the room, for example cleaning staff.

All components included in the Classroom and Patient Room Sets come under one item number. These components are installed via plug-and-play and can be used immediately without the effort of programming, making them ideal for rapid modernisation projects, even during ongoing operation. As an alternative to these pre-configured, ready-to-install sets, system components and supplementary devices can also be combined into customised ELC solutions for any application or room dimension.

### **About ESYLUX - Performance for Simplicity**

ESYLUX develops, manufactures and distributes intelligent automation and lighting solutions that ensure better quality of life and energy efficiency in office buildings, educational institutions and health facilities. People's requirements and needs are central to the company's activities. ESYLUX places particular value on the simple application of its product solutions. ESYLUX customers and partners include wholesalers, installation companies, electrical and lighting planners and architects who trust in the company's 50 years of market experience and the personal, specialist advice provided by ESYLUX experts. Furthermore, ESYLUX meets the highest quality standards in research, development and production at its German site in Ahrensburg. The sales organisation is global: ESYLUX operates on five continents in collaboration with experienced trading partners and is represented by numerous subsidiaries in Europe, Asia and Oceania.

**Find more information at [www.esylux.com](http://www.esylux.com)**

### **Press contact**

ESYLUX GmbH

Christian Schöps

Corporate Communications Consultant

**T** +49 (0) 4102 88 880-2017

**F** +49 (0) 4102 88 880-333

**E** christian.schoeps@esylux.com

## Photos and captions



### Education Set

source: *iStock/ismagilov/ESYLUX*

Education Sets from ESYLUX: pre-configured, ready-to-install integrated solutions with energy-efficient human centric lighting for classrooms measuring approx. 60 m<sup>2</sup>

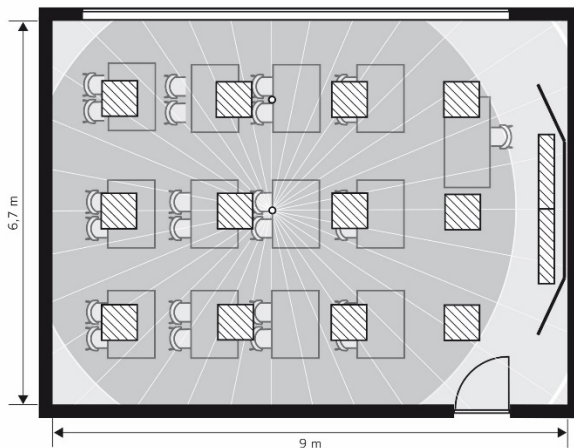

### Education Set planning example

source: *ESYLUX GmbH*

Planning example for installing an Education Set from ESYLUX in a typical classroom approx. 60 m<sup>2</sup> in size

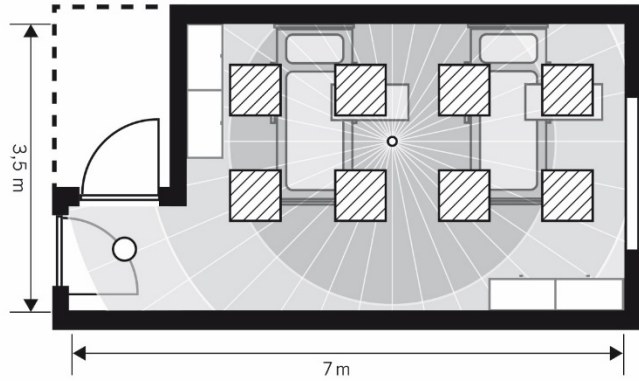

**Patient Room Set planning example**      *source: ESYLUX GmbH*

Planning example for installing a Patient Room Set from ESYLUX in a typical patient room approx. 20 m<sup>2</sup> in size



**SmartDriver Patient Room Set**      *source: ESYLUX GmbH*

An intelligent interface with ESYLUX Light Control — ELC SmartDriver