

**PRESS RELEASE**

Ahrensburg, Germany, 16 March 2021

# **Scene editor and collective processing: ESY-App update**

**With the ESY-App, users can remotely control and parameterise automation and lighting solutions that offer remote control functionality, and manage and document project configurations while on the move. In many respects, the latest version is now even easier to navigate and offers a wider range of functions. A scene editor now enables simple configuration for various scenarios, and collective processing means that multiple parameters can be transferred simultaneously.**

Parameterisation via mobile devices is becoming an increasingly popular function of technical building equipment. The ESY-App facilitates this function for intelligent automation and lighting solutions from ESYLUX — either directly using a smartphone, if the controlled device has a Bluetooth module, or in combination with the ESY-Pen, which acts as a bridge to the infrared sensor technology. An update has now provided the app with a number of new features.

## **Scene editor for simple, scenario-specific configuration**

One such addition is a scene editor, which enables simple configuration for scenario-specific control of lighting systems with ESYLUX Light Control. Once the desired button type has been selected, the output of each light channel in main and additional lighting can be individually determined per scene; in systems with Tunable White, the light colour can also be set. If a conventional end device, such as ventilation, is integrated into the system via DALI actuator, the user can switch the end device on or off per scene. As in the rest of the app, values and functions

are selected via rollers and can no longer be selected via slide controllers. This makes the app easier to use.

### **Collective processing for faster commissioning**

The ESY-App now offers the option of collective processing when parameterising devices with a wider range of functions, such as DEFENSOR outdoor motion detectors: This means that the user doesn't need to send parameter changes to the device individually; instead, they can transfer all of the changes simultaneously in a single batch. This saves a lot of time when commissioning. If necessary, the batch can then be sent to other devices of the same type with the press of a button. This cloning function significantly speeds up the process for products that are frequently used.

The ESY-App stores all parameterisations in a projection configuration automatically. As a result, even if the user has since deleted or changed the batch, all of the changes can still be transferred at a later date. This gives users the option to carry out the entire configuration process in the comfort of their office, and only send the configuration to the devices once on site. The ESY-App interface has been optimised for smartphone screens so that everything can be carried out on a smartphone.

### **Mobile project management with PDF export function**

Mobile project management on the ESY-App allows users to store and call up configurations for up to 64 floors, with up to 64 rooms per floor and up to 64 devices per room. The project file, which can be used to provide technical specifications, can be sent as a PDF document or printed. The PDF layout has been optimised in the current version to improve readability. A notes field for storing additional information has now also been added.

The ESY-App is available for download for iOS and Android in the relevant stores.

## **About ESYLUX — Performance for simplicity**

ESYLUX develops, manufactures and distributes intelligent automation and lighting solutions that ensure better quality of life and energy efficiency in office buildings, educational institutions and health facilities. People's requirements and needs are central to the company's activities. ESYLUX places particular value on the simple application of its product solutions. ESYLUX customers and partners include wholesalers, installation companies, electrical and lighting planners and architects who trust more than 50 years of market experience and the personal, specialist advice provided by ESYLUX experts. Furthermore, ESYLUX meets the highest quality standards in research, development and production at its German site in Ahrensburg. The sales organisation is global: ESYLUX operates in collaboration with experienced trading partners and is represented by numerous subsidiaries in Europe, Asia and Oceania.

**Find more information at [www.esylux.com](http://www.esylux.com)**

## **Press contact**

ESYLUX GmbH

Christian Schöps

Corporate Communications Consultant

**T** +49 (0) 4102 88 880-2017

**F** +49 (0) 4102 88 880-333

**E** christian.schoeps@esylux.com

## Photos and captions



### ESY-App

Source: iStock/hocus-focus/HRAUN

Simple parametrisation, remote control, management, documentation: the ESY-App.

*Picture in printable quality: [download](#)*

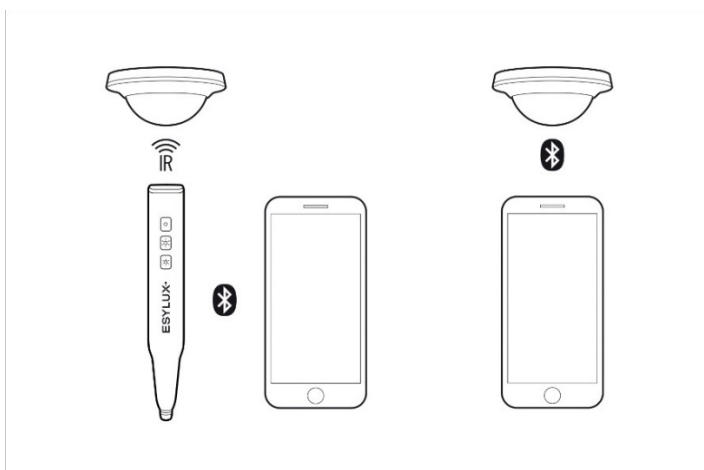

### ESY-App with or without ESY-Pen

Source: ESYLUX GmbH

The ESY-Pen acts as a bridge when transferring to infrared sensor technology. Direct sending is also possible for devices with an integrated Bluetooth module.

*Picture in printable quality: [download](#)*